

H3C WTU420H Wireless Terminator Unit Installation Quick Start-6W106

H3C WTU420H无线终结单元 快速安装指南-6W106

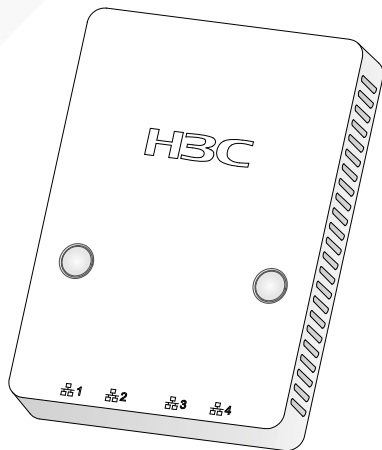

Tool list 工具参考

The installation tools are not provided with the device. Prepare them yourself.
AP不随机提供安装工具，请用户根据实际安装需求自备工具。

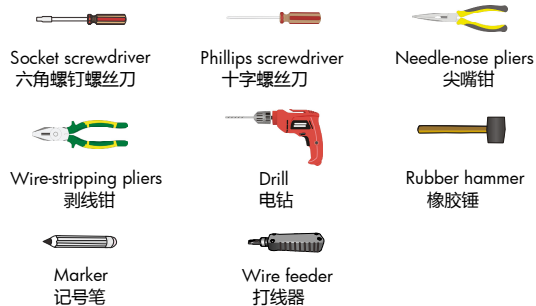

Installation accessories 安装附件介绍

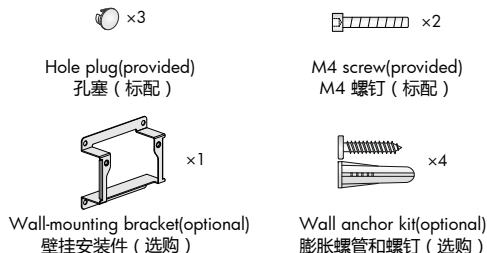

Connecting an Ethernet cable 连接以太网线

The device supports only non-standard PoE through an Ethernet cable connected to a WTU port on a WT.
设备仅支持通过以太网线连接到WT系列无线终结者的WTU PORTS接口进行非标准PoE供电。

Use an Ethernet cable with an RJ-45 connector
RJ-45连接器方式连接上行以太网接口

Use an Ethernet cable with an RJ-45 connector to connect to the Ethernet port on the AP rear.
将带有RJ-45连接器的以太网线插到AP背部的以太网接口。

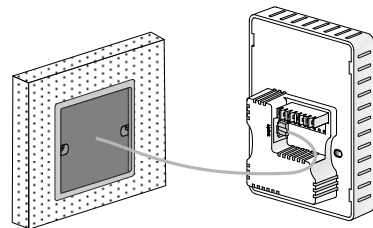

Use a punch down tool to push each wire of the Ethernet cable into the wire slots on the AP
卡线方式安装以太网线

According to the color sequence on the label below. To avoid damaging the AP, do not use excessive force.
将以太网线按照实物上标签所示的线序 (绿白、绿、蓝白、蓝、橙白、橙、棕白、棕) 安装到卡线槽上。安装网线时，请使用专门的打线器，注意力度，避免损坏设备。

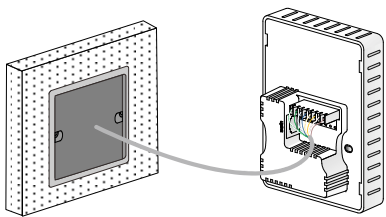

Mounting the device on a wall 安装设备到墙面

Mounting the device on a wall through an electrical outlet box
通过接线盒安装设备到墙面

Align the screw holes in the two sides of the AP with the screw holes in the wall. Use the two socket screws to secure the AP to the wall.
将AP左右两边的螺丝孔对准墙壁接线盒左右两侧的的螺丝孔，使用螺钉将AP固定到接线盒。

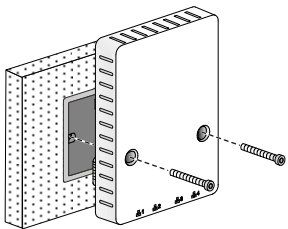

3

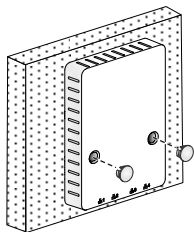

Insert two hole plugs into the two holes in the device.
按照如图所示的方向把AP的两个孔塞扣在AP上。

Mounting the device on a wall through a wall bracket
通过壁挂件安装设备到墙面

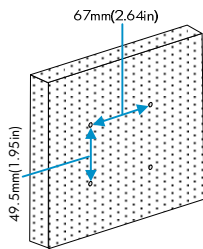

Mark the installation hole (67 mm) locations on the wall for the wall bracket. Drill holes at the marked locations. Hammer wall anchors into the holes.
在墙面使用记号笔标记出安装件安装孔的位置，使用电钻在标记处钻孔（67mm）并将膨胀螺母使用橡胶锤钉入安装孔。

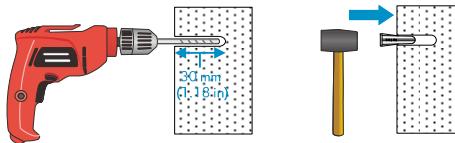

4

Use screws to attach the wall bracket to the wall.
使用螺钉将安装件固定到墙面。

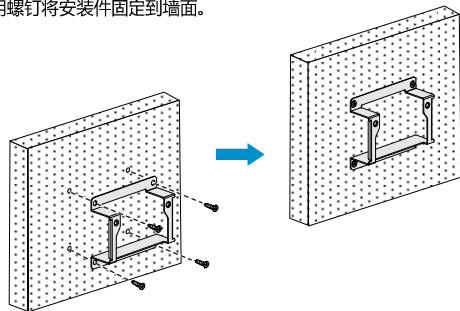

Align the screw holes in the two sides of the AP with the screw holes in the wall bracket. Use the two M4 screws to secure the AP to the wall bracket and insert the two hole plugs.
将AP左右两边的螺丝孔对准壁挂安装件左右两侧的的螺丝孔，使用螺钉将AP固定到壁挂安装件并安装设备孔塞。

