

Overview 简介

- The LSWM2SP2PM interface card provides two SFP+ ports.
LSWM2SP2PM接口模块扩展卡对外可提供2个SFP+口。

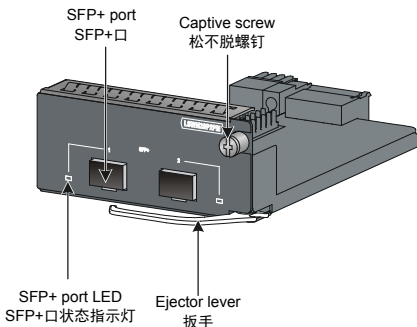

- The switch models that the LSWM2SP2PM interface card is applicable to may change over time. For the most up-to-date list of applicable switch models, contact H3C Support or marketing staff. LSWM2SP2PM接口模块扩展卡适用于H3C多款交换机产品，其适用机型的准确信息随着时间变化有更新的可能性，若您需要更详细的适配信息，请咨询H3C公司市场人员或技术支持人员。

Installing and removing the card 接口模块扩展卡的安装和拆卸

- Prepare the following tools before you install or remove the card: Phillips screwdriver, flat-blade screwdriver, and ESD wrist strap. 在安装与拆卸接口模块扩展卡前，您需要准备的工具包括十字螺丝刀、一字螺丝刀和防静电腕带。
- No installation tools are provided with the device. Prepare these tools yourself. H3C不随机提供安装工具，您需要提前准备这些安装工具。

1 Safety precautions 安全注意事项

- Before you install or remove the card, wear an ESD wrist strap and make sure the strap makes good skin contact and is reliably grounded. 在安装和拆卸过程中，操作者需自行准备并佩戴防静电腕带，请确保防静电腕带已经正确接地并与皮肤良好接触。
- To avoid device damage, do not use excessive force when you install or remove the card. 在安装和拆卸过程中，请不要用力过猛，以免对设备器件造成损坏。

2 Installing the card 接口模块扩展卡的安装

Remove the filler panel (if any) from the target slot before installing the card. Keep the removed screw and filler panel secure for future use. 如果交换机的接口模块扩展卡插槽上装有假面板，请先将假面板拆除再进行接口模块扩展卡的安装，并请妥善保管拆卸下的假面板以及固定该假面板的紧固螺钉以备将来使用。

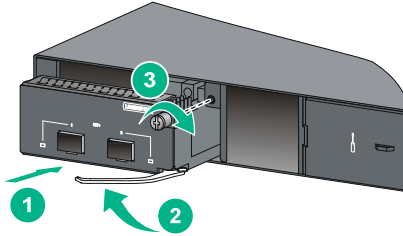

- ① Unpack the card. Insert the card slowly into the slot along the guide rails. 从包装袋中取出接口模块扩展卡，并将接口模块扩展卡沿着插槽导轨水平缓慢地推进接口模块扩展卡插槽。
- ② Rotate inward the ejector lever until the card is in close contact with the switch. 将扳手用力向内扣合，确保接口模块扩展卡和交换机紧密接触。
- ③ Use the Phillips screwdriver to tighten the captive screw on the card. 使用十字螺丝刀顺时针方向旋转，拧紧接口模块扩展卡上的松不脱螺钉。

3 Removing the card 接口模块扩展卡的拆卸

- ⚠ To avoid cable damage, remove the cables from the card before removing the card. 在拆卸接口模块扩展卡之前，推荐您先将接口模块扩展卡上的线缆拔出，以免在拆卸过程中对线缆造成损坏。
- If you are not to install a new card after removing the original one, install a filler panel in the slot to prevent dust and ensure good ventilation in the device. 若接口模块扩展卡拆卸完成后无须安装新的接口模块扩展卡，请您及时安装假面板，以保证设备的良好通风散热并防止灰尘进入设备。
- Place the removed card on an anti-static mat or in an anti-static bag. 请将拆卸下来的接口模块扩展卡及时放置到防静电垫子上或防静电袋中。

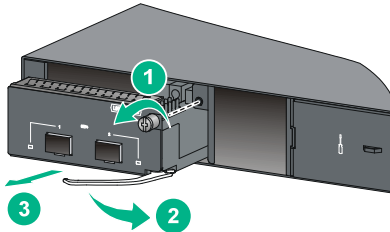

- ① Use a Phillips screwdriver to loosen the captive screw on the card.
使用十字螺丝刀逆时针方向旋转，松开接口模块扩展卡上的松不脱螺钉。
- ② Hold the ejector lever to pull the card outward until the card is disconnected from the connectors. 拉动扳手使接口模块扩展卡与设备内连接器端子脱离。
- ③ Hold the card with both hands and take it out slowly. 用双手水平缓慢地取出接口模块扩展卡。

4

Installing and removing transceiver modules and cables 光模块或线缆的安装与拆卸



For the installation and removal procedures for GE SFP transceiver modules, SFP cables, 10-GE SFP+ transceiver modules, and SFP+ cables, see *H3C Transceiver Modules and Network Cables Installation Guide* at www.h3c.com.

对于千兆SFP模块、千兆SFP电缆、万兆SFP+模块、万兆SFP+电缆的安装与拆卸，请您参见H3C网站发布的《H3C 光模块及线缆 安装指导》中的相关内容。

Verifying the installation 安装完成后的检查



After the installation is complete, determine whether the card is operating correctly. If the card fails to operate correctly, perform the following steps:

- Reinstall the card following the installation procedures described in this document.
- If the problem persists, contact H3C Support.

全部安装完成后，在交换机运行正常的情况下，若发现接口模块扩展卡无法正常工作：

- 您可以按照手册中介绍的方法重新安装接口模块扩展卡。
- 如果重新安装后，接口模块扩展卡仍无法正常工作，请您联系H3C技术支持人员。

Ports 接口



- You can install GE SFP transceiver modules, GE SFP cables, 10-GE SFP+ transceiver modules, and 10-GE SFP+ cables in the SFP+ ports. SFP+ 口可选配千兆SFP模块、SFP电缆、万兆SFP+模块、万兆SFP+电缆。
- The SFP-GE-LX-SM1310-BIDI and SFP-GE-LX-SM1490-BIDI transceiver modules must be used in pairs. SFP-GE-LX-SM1310-BIDI与SFP-GE-LX-SM1490-BIDI两款模块需要成对使用。
- H3C transceiver modules and cables available for the card are subject to change over time. For the most recent list of H3C transceiver modules and cables available for the card, contact H3C Support or marketing staff. 接口模块扩展卡支持的光模块和线缆的种类随着时间变化有更新的可能性，若您需要准确的选购信息，请咨询H3C公司市场人员或技术支持人员。
- For H3C transceiver module and cable specifications, see *H3C Transceiver Modules User Guide* at www.h3c.com. 光模块和线缆的具体规格，请您参见H3C网站发布的《H3C光模块手册》。

odel 型号	Central wavelength 中心波长	Connector 接口连接 器	Cable specifications 接口线缆规格	Modal bandwidth 模式带宽 (MHz*km)	Max transmission distance 最大传输距离
10-GE SFP+ transceiver modules 万兆 SFP+模块					
SFP-XG-LX-SM1310	1310 nm	LC	9/125μm SMF	N/A	10 km (6.21 miles)
SFP-XG-LX-SM1310-D	1310 nm	LC	9/125μm SMF	N/A	10 km (6.21 miles)
SFP-XG-LX-SM1310-E	1310 nm	LC	9/125μm SMF	N/A	10 km (6.21 miles)
SFP-XG-SX-MM850-A	850 nm	LC	50/125μm MFF	2000	300 m (984.25 ft)
				500	82 m (269.03 ft)
				400	66 m (216.54 ft)
			62.5/125μm MFF	200	33 m (108.27 ft)
160	26 m (85.30 ft)				
SFP-XG-SX-MM850-D	850 nm	LC	50/125μm MFF	2000	300 m (984.25 ft)
				500	82 m (269.03 ft)
				400	66 m (216.54 ft)
			62.5/125μm MFF	200	33 m (108.27 ft)
160	26 m (85.30 ft)				
SFP-XG-SX-MM850-E	850 nm	LC	50/125μm MFF	2000	300 m (984.25 ft)
				500	82 m (269.03 ft)
				400	66 m (216.54 ft)
			62.5/125μm MFF	200	33 m (108.27 ft)
160	26 m (85.30 ft)				
GE SFP transceiver modules 千兆 SFP 模块					
SFP-GE-SX-MM850-A	850 nm	LC	50/125μm MFF	500	550 m (1804.46 ft)
				400	500 m (1640.42 ft)
			62.5/125μm MFF	200	275 m (902.23 ft)
				160	220 m (721.78 ft)
SFP-GE-SX-MM850-D	850 nm	LC	50/125μm MFF	500	550 m (1804.46 ft)
				400	500 m (1640.42 ft)
			62.5/125μm MFF	200	275 m (902.23 ft)
				160	220 m (721.78 ft)

odel 型号	Central wavelength 中心波长	Connector 接口连接 器	Cable specifications 接口线缆规格	Modal bandwidth 模式带宽 (MHz*km)	Max transmission distance 最大传输距离
SFP-GE-LX- SM1310-A	1310 nm	LC	9/125μm SMF	N/A	10 km (6.21 miles)
			50/125μm MFF	500/400	550 m (1804.46 ft)
			62.5/125μm MFF	500	550 m (1804.46 ft)
SFP-GE-LX- SM1310-D	1310 nm	LC	9/125μm SMF	N/A	10 km (6.21 miles)
SFP-GE-LH 40-SM1310	1310 nm	LC	9/125μm SMF	N/A	40 km (24.86 miles)
SFP-GE-LH4 0-SM1310-D	1310 nm	LC	9/125μm SMF	N/A	40 km (24.86 miles)
SFP-GE-LH 40-SM1550	1550 nm	LC	9/125μm SMF	N/A	40 km (24.86 miles)
SFP-GE-LH 70-SM1550	1550 nm	LC	9/125μm SMF	N/A	70 km (43.50 miles)
SFP-GE-LH 80-SM1550	1550 nm	LC	9/125μm SMF	N/A	80 km (49.71 miles)
SFP-GE-LH8 0-SM1550-D	1550 nm	LC	9/125μm SMF	N/A	80 km (49.71 miles)
SFP-GE-LH 100-SM1550	1550 nm	LC	9/125μm SMF	N/A	100 km (62.14 miles)
SFP-GE-LX- SM1310-BI DI	TX : 1310 nm RX : 1490 nm	LC	9/125μm SMF	N/A	10 km (6.21 miles)
SFP-GE-LX- SM1490-BI DI	TX : 1490 nm RX : 1310 nm	LC	9/125μm SMF	N/A	10 km (6.21 miles)
SFP-GE-T	-	RJ-45	Twisted pair 双绞线	N/A	100 m (328.08 ft)
SFP-GE-T-D	-	RJ-45	Twisted pair 双绞线	N/A	100 m (328.08 ft)

Model 型号	Cable length 线缆长度	Data rate 传输速率
10-GE SFP+ cables 万兆 SFP+电缆		
LSWM1STK	0.65 m (2.13 ft)	10.31 Gbps
LSWM2STK	1.2 m (3.94 ft)	
LSWM3STK	3 m (9.84 ft)	
LSTM1STK	5 m (16.40 ft)	
GE SFP cables 千兆 SFP 电缆		
SFP-STACK-Kit	1.5 m (4.92 ft)	1250 Mbps

LEDs 接口状态指示灯

 The SFP+ port LEDs are not affected by the port LED mode switching button on your switch. For more information about the port LED mode switching button, see the installation guide for the switch. 该指示灯不受交换机上端口状态指示灯模式切换按钮的影响，关于端口状态指示灯模式切换按钮的详细介绍请参见交换机的配套安装手册。

LED Status 指示灯状态	Description 指示灯含义
Steady green 绿色常亮	A transceiver module is installed in the port. The port is operating at 10 Gbps, and a link is present on the port. 模块已安装，端口工作在10G模式下，并且端口Link Up
Flashing green 绿色闪烁	The port is sending or receiving data at 10 Gbps. 端口工作在10G模式下，正在接收或发送数据
Steady yellow 黄色常亮	A transceiver module is installed in the port. The port is operating at 1 Gbps, and a link is present on the port. 模块已安装，端口工作在1G模式下，并且端口Link Up
Flashing yellow 黄色闪烁	The port is sending or receiving data at 1 Gbps. 端口工作在1G模式下，正在接收或发送数据
Off 灯灭	No transceiver module is installed in the port, or no link is present on the port. 模块没有安装或端口没有Link Up